

## ANBAC BRAND STORY

Since 2000,  
Eyeguard Co., Ltd. has made an effort to increase people's eye health.  
With the launch of our brand ANBAC,  
we continue to produce eye protective screen filters.

ANBAC aims to keep the body and mind healthy by protecting the eyes.

An old Korean proverb states,

"If the value of our body is 1000, the eyes take up 900."

The eyes are closely connected to our brain than any other organ in our body,  
giving it the name "the window to the soul".

Despite its importance, it is also the busiest functioning organ in our body.  
It works all day except when we are sleeping, making it prone to constant fatigue.  
With virtue of this concern, we care.

## USER MANUAL

HANG TYPE

---

**ANBAC.CO**

International customers

**ANBAC.KR**

Korean customers

## ● COMPONENTS (SEAMLESS TYPE FILTER) 일체형 필터 구성품

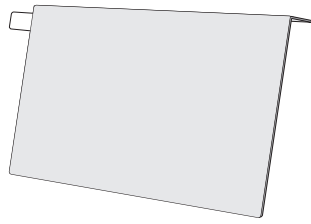

ANBAC SCREEN FILTER  
안박 스크린 필터



CLEANING CLOTH  
극세사 천

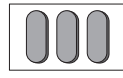

FOAM PAD  
폼패드

## ● CAUTION (SEAMLESS TYPE FILTER) 일체형 필터 주의사항

- Depending on the model, protective layer must be removed on either one or both sides.
- Do not make contact with any sharp objects or handle with excessive force.
- Do not clean the filter using any type of organic solvent (such as alcohol or benzene).

- 사용 전 제거해야 하는 보호지는 모델에 따라 단면 혹은 양면에 있어요.
- 날카로운 도구로 필터 표면을 찌르거나 필터 취급시 과도한 힘을 사용하지 마세요.
- 필터 청소시 유기용제(알코올 혹은 벤젠 계열)를 사용하지 마세요.

## ● INSTALLATION GUIDE (SEAMLESS TYPE FILTER) 일체형 필터 설치방법

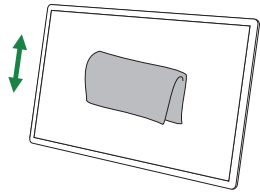

1. Clean your screen with the cleaning cloth

1. 화면을 극세사 천으로 깨끗이 닦아주세요

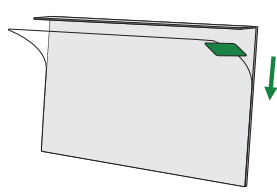

2. Remove protective layer from filter (both side if applicable)

2. 필터에 붙어있는 보호지를 제거해주세요

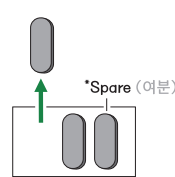

3. Detach foam pad from adhesive backing

3. 폼 패드를 접착면 보호지로부터 떼어내주세요

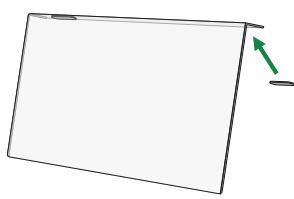

4. Attach the pads under the hook of the filter  
4. 폼 패드를 필터의 고리 아래 부분에 붙여주세요

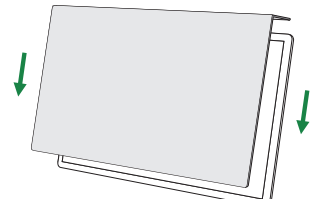

5. Hang the filter on your monitor  
5. 필터를 모니터 앞에 걸어주세요

## ■ COMPONENTS (ASSEMBLY TYPE FILTER) 조립형 필터 구성품

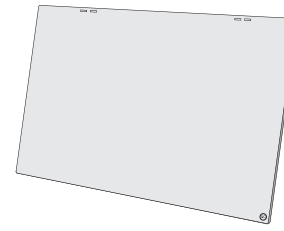

ANBAC SCREEN FILTER  
안박 스크린 필터



CLEANING CLOTH  
극세사 천



HOOK (2 pcs)  
고리

## ■ CAUTION (ASSEMBLY TYPE FILTER) 조립형 필터 주의사항

- Distinguish front side of filter & place it towards you. It has a QC mark on the right bottom corner.
- Do not make contact with any sharp objects or handle with excessive force.
- Do not clean the filter using any type of organic solvent (such as alcohol or benzene).

- 필터의 앞면을 구분하여 사용자의 방향으로 향하게 설치해주세요. 앞면은 하단 우측 부분에 QC 마크가 있어요.
- 날카로운 도구로 필터 표면을 찌르거나 필터 취급시 과도한 힘을 사용하지 마세요.
- 필터 청소시 유기용제(알코올 혹은 벤젠 계열)를 사용하지 마세요.

## ■ INSTALLATION GUIDE (ASSEMBLY TYPE FILTER) 조립형 필터 설치방법

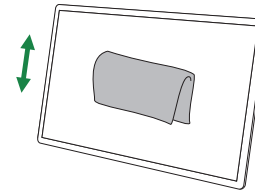

1. Clean your screen with the cleaning cloth

1. 화면을 극세사 천으로 깨끗이 닦아주세요

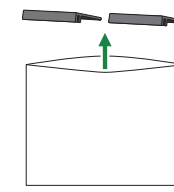

2. Unpack hook parts from the envelope

2. 봉투에 담겨있는 고리 부품을 꺼내주세요

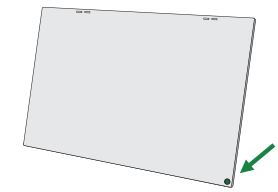

3. Distinguish front side of filter (it has a QC mark)

3. 필터의 앞면을 구분해주세요 (앞면에는 QC 마크가 있어요)

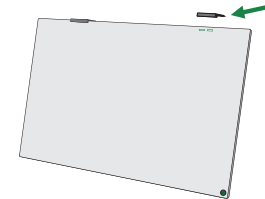

4. Mount the hooks on the top side of the filter  
4. 고리를 필터 상단의 구멍에 맞춰 장착해주세요.

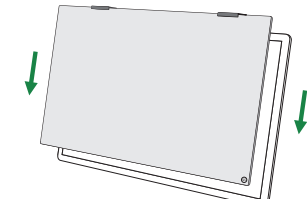

5. Hang the filter on your monitor  
5. 필터를 모니터 앞에 걸어주세요